

**ELEVATION**

ALW24F - 2400 X 1200  
ALW18F - 1800 X 1200  
ALW15F - 1500 X 1200  
ALW24AF - 2400 X 1500  
ALW18AF - 1800 X 1500  
ALW15AF - 1500 X 1500

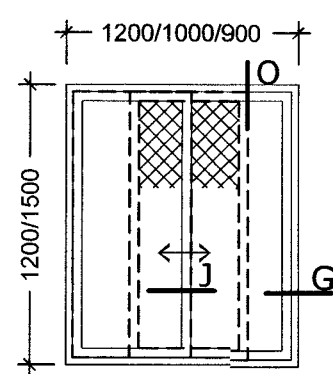

**ELEVATION**

ALW12F - 1200 X 1200  
ALW10F - 1000 X 1200  
ALW9F - 900 X 1200  
ALW12AF - 1200 X 1500  
ALW10AF - 1000 X 1500  
ALW9AF - 900 X 1500

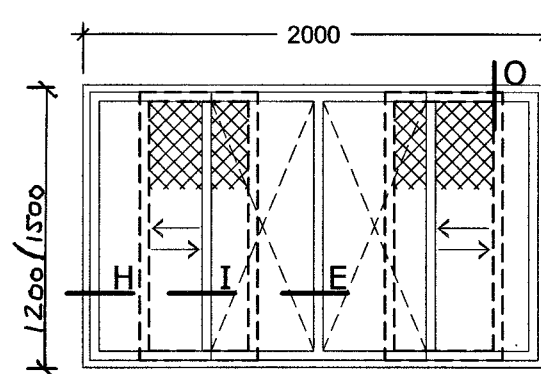

**ELEVATION**

ALW20F - 2000 X 1200  
ALW20AF - 2000 X 1500

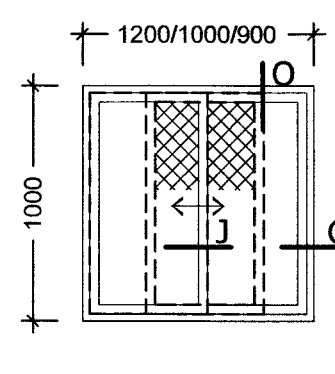

**ELEVATION**

ALWK12F - 1200 X 1000  
ALWK10F - 1000 X 1000  
ALWK9F - 900 X 1000

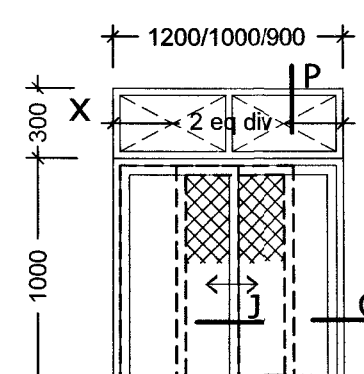

**ELEVATION**

ALWK 12FX - 1200 X 1300  
ALWK 10FX - 1000 X 1300  
ALWK 9FX - 900 X 1300

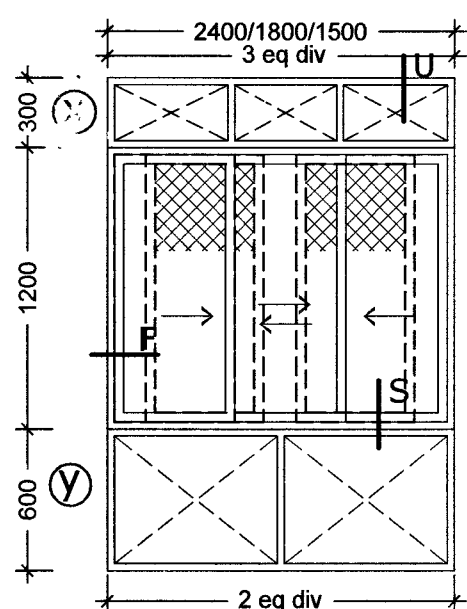

**ELEVATION**

ALW 24FX - 2400 X 2100  
ALW 18FX - 1800 X 2100  
ALW 15FX - 1500 X 2100

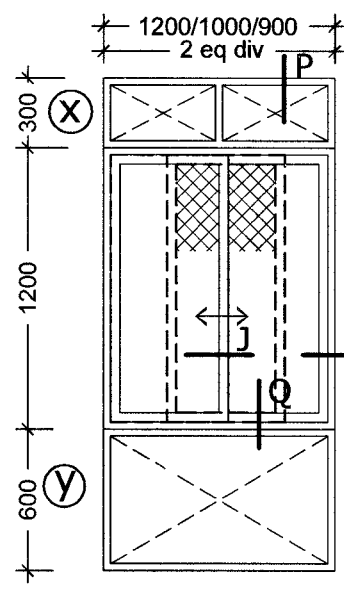

**ELEVATION**

ALW 12FX - 1200 X 2100  
ALW 10FX - 1000 X 2100  
ALW 9FX - 900 X 2100

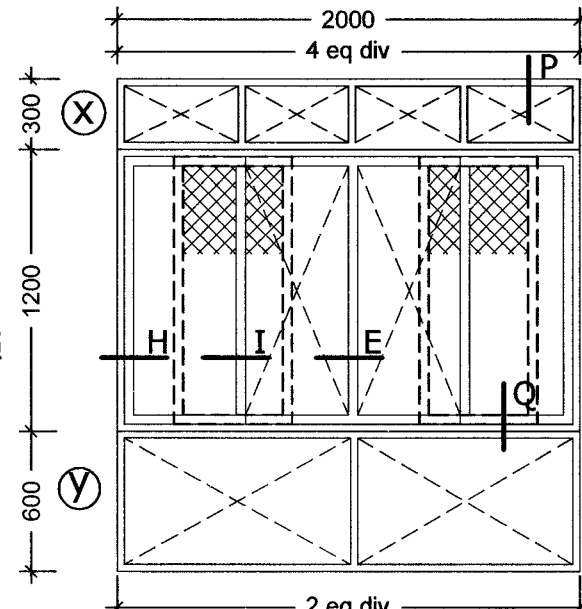

**ELEVATION**

ALW 20FX - 2000 X 2100

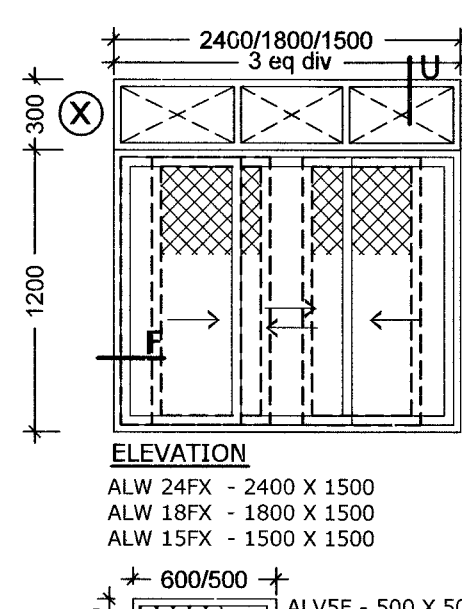

**ELEVATION**

ALW 24FX - 2400 X 1500  
ALW 18FX - 1800 X 1500  
ALW 15FX - 1500 X 1500

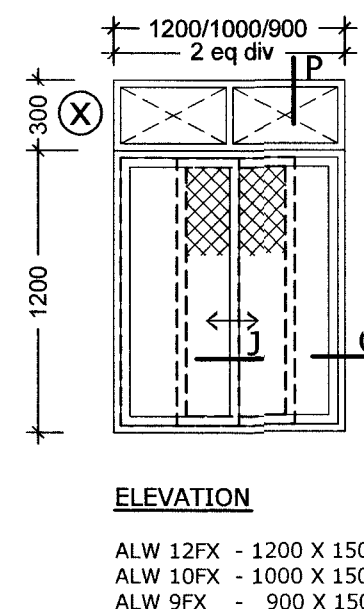

**ELEVATION**

ALW 12FX - 1200 X 1500  
ALW 10FX - 1000 X 1500  
ALW 9FX - 900 X 1500

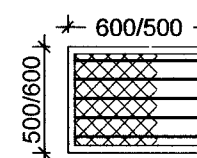

**ELEVATION**

ALV5F - 500 X 500  
ALV6F - 600 X 500  
ALV5AF - 500 X 600  
ALV6AF - 600 X 600

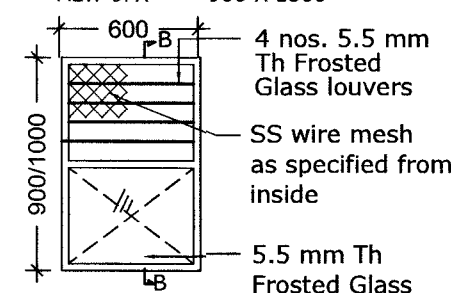

**ELEVATION**

ALW6F - 600 X 900  
ALW6AF - 600 X 1000

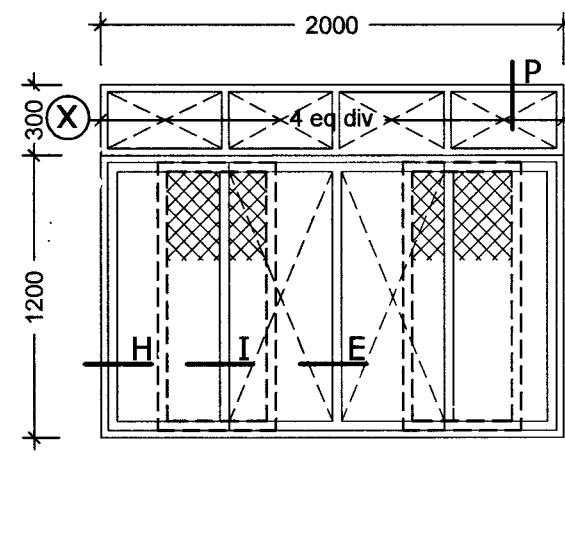

**ELEVATION**

ALW 20FX - 2000 X 1500

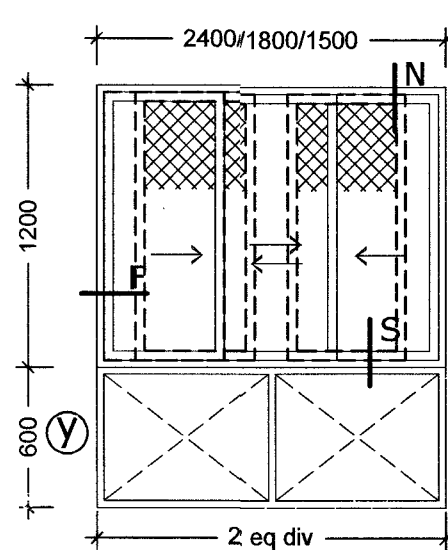

**ELEVATION**

ALW 24FY - 2400 X 1800  
ALW 18FY - 1800 X 1800  
ALW 15FY - 1500 X 1800

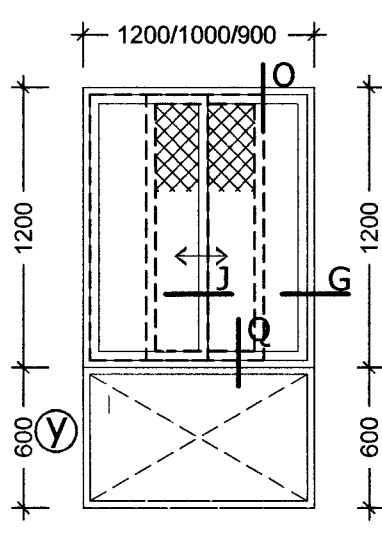

**ELEVATION**

ALW 12FY - 1200 X 1800  
ALW 10FY - 1000 X 1800  
ALW 9FY - 900 X 1800

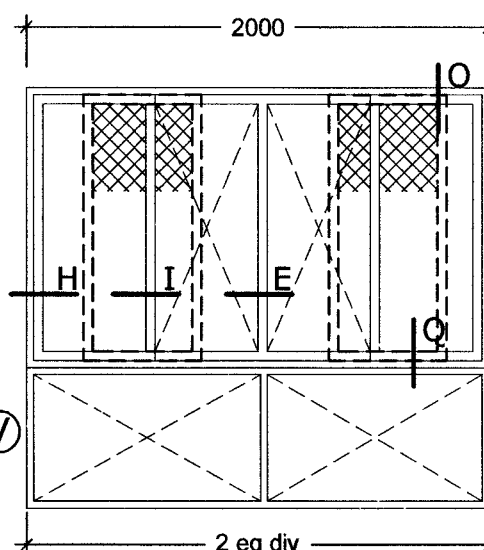

**ELEVATION**

ALW 20FY - 2000 X 1800

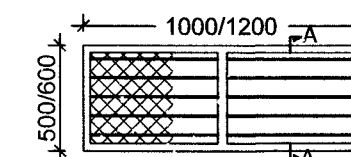

**ELEVATION**

ALV10F - 1000 X 500  
ALV12F - 1200 X 500  
ALV10AF - 1000 X 600  
ALV12AF - 1200 X 600

**NOTES**

- Tolerance of 5 mm on overall size of window frame on either side (horizontal & vertical) shall be permitted after allowing 15 mm plaster on Bk/Conc surfaces.
- Cill as per detail shall be provided for all windows, even if it is not shown in the Arch Main drgs.
- Drawings are prep using Jindal extrusions, however the Aluminium Extrusions can be used either of Jindal or Hindalco or any equivalent make as listed in Tender.
- Fixing of profiles & glazing shall be done conforming IS 1081.
- The weight / sizes of the sections may vary by 5% on either side.
- All the Aluminium extrusions/sections shall be powder coated with 50 to 60 µm of approved colour.
- Glass panes shall be of min 5.5 mm th plain glass unless otherwise mentioned in the contract document.
- Make & specification of high performing glass which reduces direct/indirect heat is enclosed at Appx 'B' P S clause may be included in tender, for sliding windows (SGHS- solar heat gaining coefficient) SHGC<0.45, (VLT-visual light transmissioin) VLT>35, for sliding door balcony SHGC<0.45, VLT>38.
- Stainless steel wire mesh shall be stainless steel wire cloth conforming to IS having "not less than 0.40 mm dia" of wire and 1.4 mm average width of aperture all as specified in SSR part -I.
- Aluminium sections incorporated in windows / ventilators shall confirm to designation 63400 given in IS:733.
- All sliding windows, corner joinery for frame & shutter should be provided with self locating corner connectors ( Die cast) or as per manufactureres instructions.
- No joinery shall be permitted with angles and screws.
- Fabrication should be done with approved fabricators. No fabrication on site shall be allowed.
- Weight and size of all aluminium extrusions / sliding windows / ventilators shown in TD drg. are minimum in case of non availability of these sections in the market, the contractor shall check and provide the sections with weight more than the minimum specified weight of approved manufacturers.

S No	DATE	DESCRIPTION	INITIAL
REVISIONS			
ALUMINUM SLIDING WINDOWS (WITH MOSQUITO PROOFING)			
ELEVATIONS			
Date	20-06-2022	CHIEF ENGINEER (NAVY)	Sheet No
Drawn	NK Vikram	VISAKHAPATNAM	2 / 4
Tcd		ZONE	
Ckd	K S Vani		
Scale		REF DRG NO : CEVZ / 2022 / TD -13	
KSVani		Signature	Signature
AAD (Arch)		Jt Director (Arch)	Director (Arch) For Chief Engineer

**REVISIONS**

**ALUMINUM SLIDING WINDOWS (WITH MOSQUITO PROOFING)**

**ELEVATIONS**

Date	20-06-2022	CHIEF ENGINEER (NAVY)	Sheet No
Drawn	NK Vikram	VISAKHAPATNAM	2 / 4
Tcd		ZONE	
Ckd	K S Vani		
Scale		REF DRG NO : CEVZ / 2022 / TD -13	

AAD (Arch)

Jt Director (Arch)

Director (Arch)  
For Chief Engineer